

TVONICS

All you need to enjoy digital TV

MDR-250 Quick Start Guide

Freeview



1 Inserting batteries into the remote control

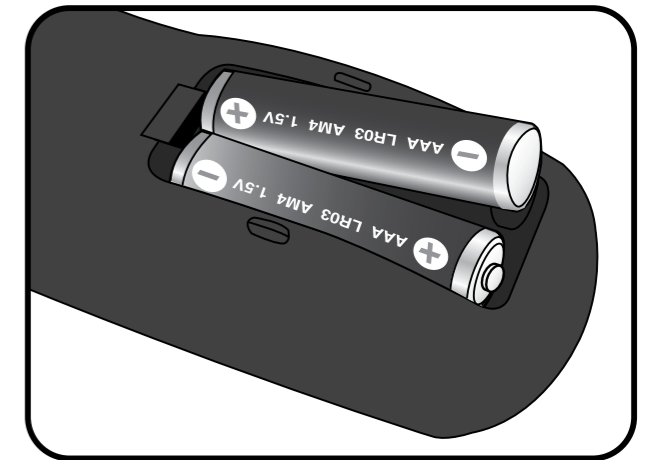
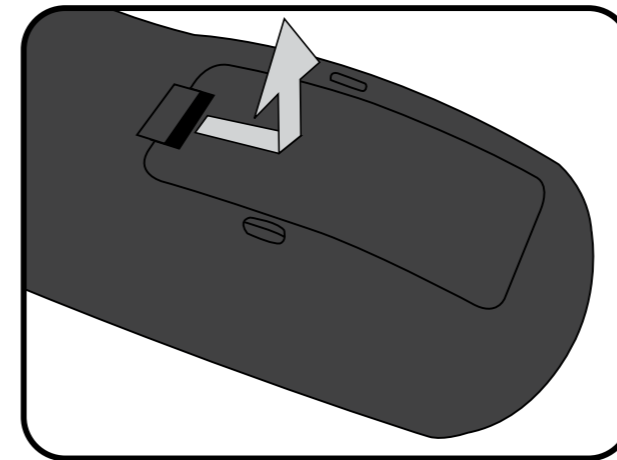

- Always check the positive/negative symbols on the batteries to ensure they are inserted correctly.

2a Connecting to a TV with a SCART socket

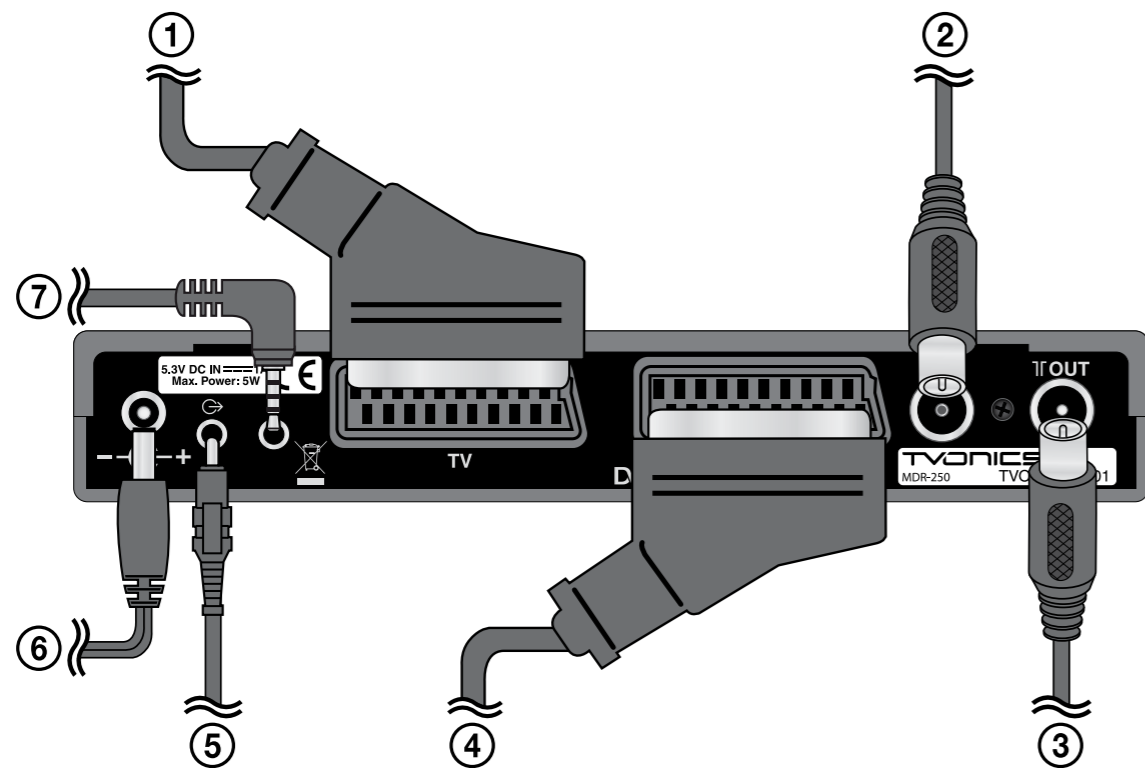

- ① To your TV (supplied SCART lead).
- ② From your aerial.
- ③ To your TV or VCR/DVD Recorder (supplied RF lead).
- ④ To your VCR or DVD Recorder (SCART lead not supplied).
- ⑤ To your Hi-Fi/Surround Sound System (3.5mm jack plug lead/optical lead not supplied).
- ⑥ To the mains power outlet (supplied power supply).
Do not cut off the supplied power supply's plug.
- ⑦ Supplied remote control extender (only required when installing the Freeview box out of sight or behind your TV).

2b Connecting to a TV without a SCART socket

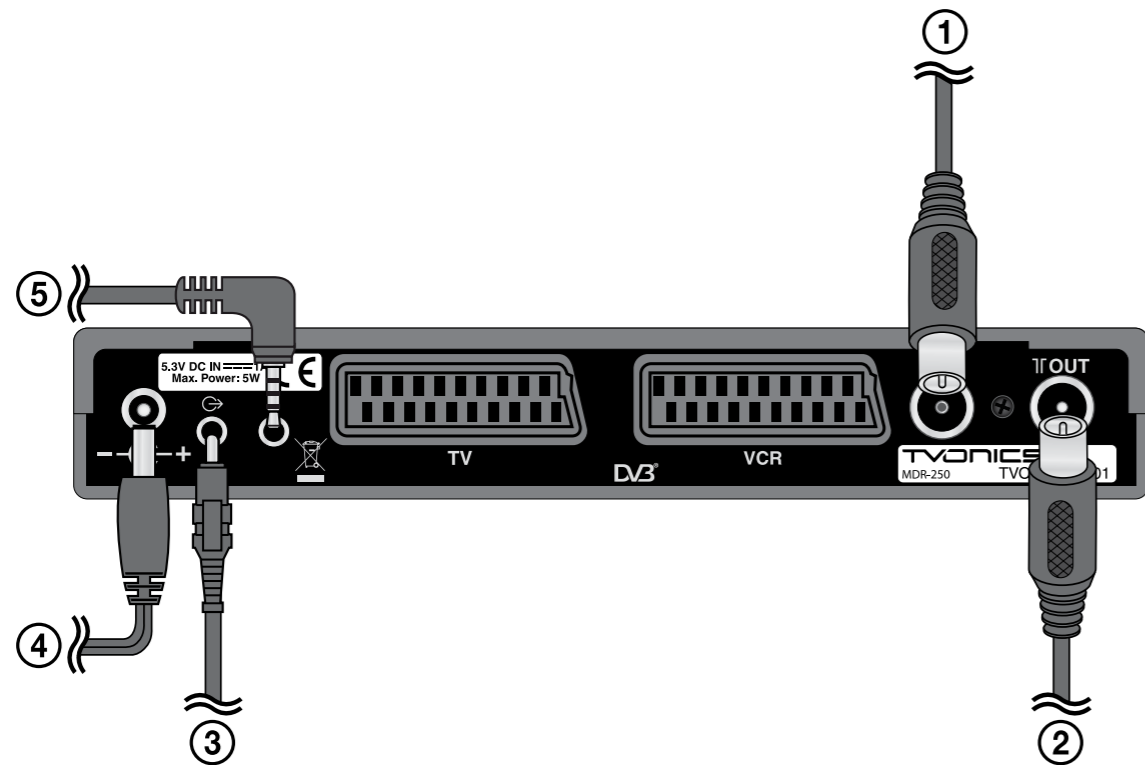

- ① From your aerial.
- ② To your TV or VCR/DVD Recorder (supplied RF lead).
- ③ To your Hi-Fi/Surround Sound System (3.5mm jack plug lead/optical lead not supplied).
- ④ To the mains power outlet (supplied power supply).
Do not cut off the supplied power supply's plug.
- ⑤ Supplied remote control extender (only required when installing the Freeview box out of sight or behind your TV).

You will now need to tune a spare channel on your TV to view pictures from the Freeview box.

Ensure the Freeview box is switched on before tuning the TV.

To automatically tune a spare channel on your TV:

1. Use your TV's 'automatic tune' option to retune your TV (refer to your TV's user guide for more information). The Freeview box must be switched on in order for the TV to detect it.
2. Once the automatic tuning has finished, use your TV's remote control to find the channel that displays the Freeview box's picture. You should see the Start up screen, shown in section 3.
3. Whenever you want to view pictures from the Freeview box, you will need to select this channel first.

To manually tune a spare channel on your TV:

1. Use your TV's remote control to select a spare channel on your TV.
2. Use your TV's 'manual tune' option to search for the Freeview box (refer to your TV's user guide for more information). The Freeview box automatically outputs a signal on UHF Channel 38*. Alternatively, if your TV allows you to enter the channel frequency directly, the Freeview box's output frequency is 607.25 MHz. Once the channel has been tuned you should see Start up screen, shown in section 3.
3. Store this channel on your TV. Whenever you want to view pictures from the Freeview box, you will need to select this channel first.

*If UHF Channel 38 is already in use, or interference lines appear on the picture, set the Freeview box's output signal to a different UHF Channel and retune your TV. Refer to "RF Output" on page 26 of the user guide.

3 Automatically tuning

The first time you switch on your Freeview box you will see a screen like the one shown below.

Press the **[OK]** button on the remote control to begin automatic tuning.

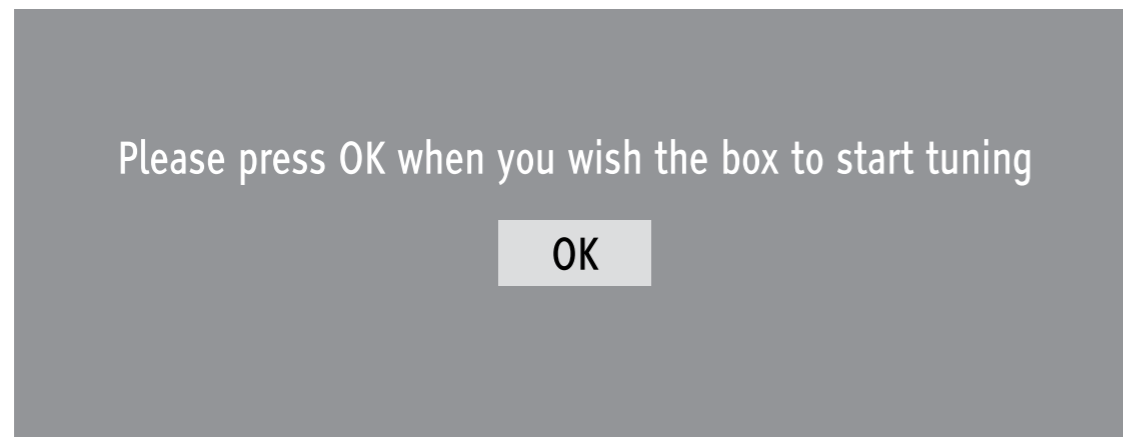

When automatic tuning has finished, a summary screen is displayed. Press the **[OK]** button to remove the summary screen and start watching digital TV.